



City of Fontana Planning Department

APPROVED



PROJECTS





Southridge Dog Park

MCN 21-021

Location: 14501 Live Oak Ave.

Construction Timeline: Expected to start 2022

Southridge Dog Park will consist of two dog fields across .53 acres. The park will offer amenities including tables, benches, drinking fountains, and hand washing stations.



South Fontana Park

MCN 19-105

Location: southeast corner of Cypress Ave. and Santa Ana Ave.

Construction Timeline: Expected to start 2022

South Fontana Park will provide residents with four new soccer fields, concession stands, and picnic areas for recreation.

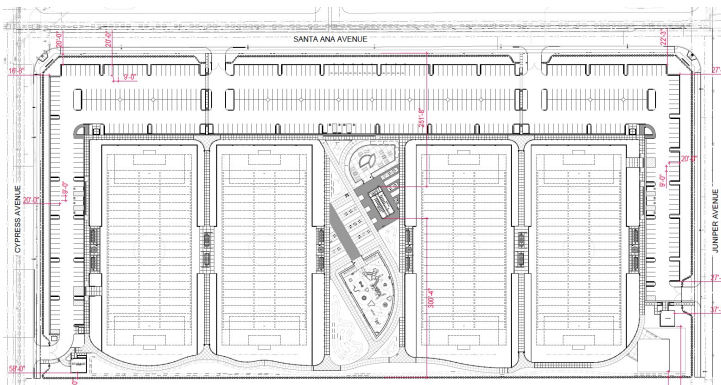

Rock of Salvation Church

MCN 19-092

Location: 17993 Foothill Blvd.

Construction Timeline: Expected to start Spring 2022

Rock of Salvation church is Fontana's newest place of public assembly. Located along Fontana's historic Route 66, The church will help transform a portion of the street in between Laurel and Locust.



Central Park

PLN 11-003

Location: 8320—8334 Cypress Ave.

Construction Timeline: Complete

Central Park is a new park that provides residents with new recreational opportunities including a soccer field, two football fields, a tot lot, picnic areas, and a relocated community garden.



Northgate Market Shopping Center

MCN 20-016

Location: Northwest corner of Sierra Ave. and San Bernardino Ave.

Construction Timeline: Expected to start Winter 2022

A new shopping center has been approved for Central Fontana. Occupying the location of a former car dealership the new shopping center will be anchored by Northgate Market, the first in the City. The shopping center will also include various new tenants as well as drive through pads.



Chrysler, Dodge, Ram and Jeep Dealership

MCN 20-042

Southwest corner of South Highland and Oleander Avenue

Construction Timeline: Completion expected Winter 2022

Another dealership which was recently approved is the new Chrysler, Dodge, and Jeep dealership. The dealership will be a 46,073 sq. ft. in size and will include a service center and a carwash area. It is the latest development along Fontana's Auto mall. When complete the auto mall, located along South Highland Avenue, will be a regional destination for resident's auto related needs.

Hyundai Dealership

MCN 20-036

Location: Northwest corner of Sierra Ave. and South Highland Ave.

Construction Timeline: Complete

A new dealership has come to Fontana's Auto mall. The new Hyundai dealership is a new 30,168 sq. ft. facility which is slated to open soon. The dealership is part of the recent wave of commercial development along South Highland Avenue.





La Quinta Hotel

MCN 19-091

Location: Southeast corner Juniper Ave. and Slover Ave.

Construction Timeline: Under construction

La Quinta Hotel is coming to Fontana. The new hotel will consist of four stories and will have 111 rooms. Amenities for the hotel will include an outdoor pool and spa, a fitness center, laundry room, and continental breakfast area.

ARCO Gas Commercial Center



MCN 20-056

Location: Southwest corner of Alder Ave. and Foothill Blvd.

Construction Timeline: Expected to start Spring 2022

The commercial development on the southwest corner of Foothill and Alder Avenue will include a carwash, gas station, convenience store, and a commercial suite. The proposed building will be in Art deco style as an homage to Historic Route 66.



7-Eleven

MCN 20-028

Location: Northeast corner of Mango Ave. and Sierra Lakes Pkwy.

Construction Timeline: Expected to start Winter 2022

7-Eleven will soon construct a new building on the northeast corner of Mango Avenue and Sierra Lakes Parkway.



Marriott Towne Place Suites

MCN 19-031

Location: 10530 Sierra Ave.

Construction Timeline: Expected to start Winter 2022

Fontana will soon be home to Marriott Towne Place Suites. The hotel along with the newly approved La Quinta Hotel will seek to offer more opportunities for over night accommodation for visitors to the City.



Ventana Specific Plan—Planning Area 6

MCN 20-099

Location: Northwest corner of Duncan Canyon Rd. and Citrus Ave.

Construction Timeline: Expected to start Spring 2022

Planning Area 6 of the Ventana Specific Plan brings a taste of Europe to Fontana. The project consist of 257 units and will have many recreational amenities including a fitness center, pool area, recreation room, and open plazas. Paseos and walkways will weave through the project to give it an old world feel.

La Sierra Housing



MCN 20-032

Location: 16796 Montgomery Avenue

Construction Timeline: Expected to start Fall 2022

Seniors will have more housing options coming soon with the approval of the La Sierra Senior Housing project which will provide 58 units for senior citizens. The project is designed in a courtyard style and includes amenities such as a spa, a putting green, and a community lounge.

Fontana Garden Senior Apartments



MCN 19-101

Location: Southwest corner of Mango Ave. and Walnut Village Pkwy.

Construction Timeline: Expected to start Winter 2022

Fontana Garden Senior Apartments is currently under plan check and is set to start construction soon. This is part of another wave of senior housing developments that the City has processed. The demand for senior housing has increased in the City as more people are entering retirement and selling their homes to downsize.



Stratham Homes

MCN 19-096

Location: Southeast corner of Victoria Street and Etiwanda Creek

Construction Timeline: Expected to start Fall 2021

This development will be a 107 unit condominium project. The project will have a central area with a pool and spa. A small park and a dog park have also been provided onsite.



Mountain View Homes

MCN 18-107R2

Location: 5253 Lytle Creek Road

Construction Timeline: Under Construction

Mountain View Homes is a proposal for 156 single family homes across 34 acres.



Monarch Hills

MCN 16-012

Location: North of Lytle Creek Rd. and Duncan Canyon Rd.

Construction Timeline: Expected to start to start Fall 2021

Monarch Hills is a new community north of Interstate 15 and Lytle Creek Road situated along the San Bernardino Mountains. The community will create 489 new housing units that will be available in various housing types such as single family homes, townhomes, and condos.



Monterado



MCN 18-096

Location: APN 0239-081-45

Construction Timeline: Under Construction

Monterado will be a new community of 198 housing units that will have several amenities including a pool and spa, BBQ area, tot lots, and open space areas. These amenities will be connected through a series of walkways that span the community.



Shady Trails Planning Area 16

MCN 19-119

Location: APN 1107-262-50

Construction Timeline: Under Construction

Planning Area 16 of the Shady Trails Specific Plan will consist of 139 condominiums across 25 complexes.



Cypress Multi-Family Apartment

MCN 21-042

Location: Southeast corner of Foothill Blvd. and Date St.

Construction Timeline: Construction expected to start Winter 2021-2022

Cypress multi-family apartments will consist of a 106 unit multi family complex. It is among the first of many projects located in the City's new Form Based Code which seeks to promote walkability and connectivity in the Downtown and major corridors by offering more flexible development standards. The project will include amenities such as a recreation center, pool, barbeque areas, and open space areas.



Summit at Rosena Specific Plan

Location: northwest corner of Sierra Ave. and Summit Ave.

Construction Timeline: On Going

Summit at Rosena is a planned community that is an ongoing project. Several planning areas have been built and some are currently in construction. At its completion the community will provide over 850 housing units. The community will also have several amenities including an Olympic sized swimming pool in a one acre community center area.

4122 Monterey



2470 California Ranch



3251 Craftsman



2449 American Farmhouse



Arboretum Specific Plan

Location: Northwest corner of Casa Grande Ave. and Sierra Ave.

Construction Timeline: On Going

The Arboretum Specific Plan is an ongoing project that will ultimately create 3,500 housing units for residents in the City at its completion. This is currently the City's largest planned community.